



# GTW9S

## 电梯曳引机 ELEVATOR TRACTION MACHINE

电源电压 Voltage : 380V  
 悬挂比 Suspension : 2 : 1  
 FZD12A 制动器 Brake : DC110V 2×1.0A  
 最大静态载荷 Max.Static Load : 3000kg

规格号 Spec	载重 Load (kg)	梯速 Lift Speed (m/s)	推荐高度 Height (m)	曳引轮直径 Sheave Diam(mm)	绳轮 Rope Sheave (mm)	额定电流 Current (A)	额定转矩 Torque (Nm)	额定转速 Rated Speed (rpm)	额定频率 Frequency (Hz)	功率 Power (kW)	极数 Pole	工作制 Rating	绝缘等级 INS.Class	防护等级 IP Code
GTW9S-61P0A	630	1	≤80	Φ400	4×Φ10×16	9.7	389	96	25.6	3.9	32	S5(40%)	F	IP41
GTW9S-61P5A	630	1.5	≤80	Φ400	4×Φ10×16	14.9	420	144	38.4	6.3	32	S5(40%)	F	IP41
GTW9S-61P6A	630	1.6	≤80	Φ400	4×Φ10×16	14.9	420	153	40.8	6.7	32	S5(40%)	F	IP41
GTW9S-61P7A	630	1.75	≤80	Φ400	4×Φ10×16	15.9	420	167	44.5	7.3	32	S5(40%)	F	IP41
GTW9S-62P0A	630	2	≤80	Φ400	4×Φ10×16	18.3	420	192	51.2	8.4	32	S5(40%)	F	IP41
GTW9S-81P0A	800	1	≤80	Φ400	5×Φ10×16	12.1	502	96	25.6	5.0	32	S5(40%)	F	IP41
GTW9S-81P5A	800	1.5	≤80	Φ400	5×Φ10×16	18.8	530	144	38.4	8.0	32	S5(40%)	F	IP41
GTW9S-81P6A	800	1.6	≤80	Φ400	5×Φ10×16	18.8	530	153	40.8	8.5	32	S5(40%)	F	IP41
GTW9S-81P7A	800	1.75	≤80	Φ400	5×Φ10×16	20.7	530	167	44.5	9.3	32	S5(40%)	F	IP41
GTW9S-82P0A	800	2	≤80	Φ400	5×Φ10×16	23.2	530	192	51.2	10.7	32	S5(40%)	F	IP41
GTW9S-101P0A	1000	1	≤80	Φ400	5×Φ10×16	14.7	604	96	25.6	6.1	32	S5(40%)	F	IP41
GTW9S-101P5A	1000	1.5	≤80	Φ400	5×Φ10×16	22.9	650	144	38.4	9.8	32	S5(40%)	F	IP41
GTW9S-101P6A	1000	1.6	≤80	Φ400	5×Φ10×16	22.9	650	153	40.8	10.4	32	S5(40%)	F	IP41
GTW9S-101P7A	1000	1.75	≤80	Φ400	5×Φ10×16	25.1	650	167	44.5	11.4	32	S5(40%)	F	IP41
GTW9S-102P0A	1000	2	≤80	Φ400	5×Φ10×16	28.2	650	192	51.2	13.1	32	S5(40%)	F	IP41

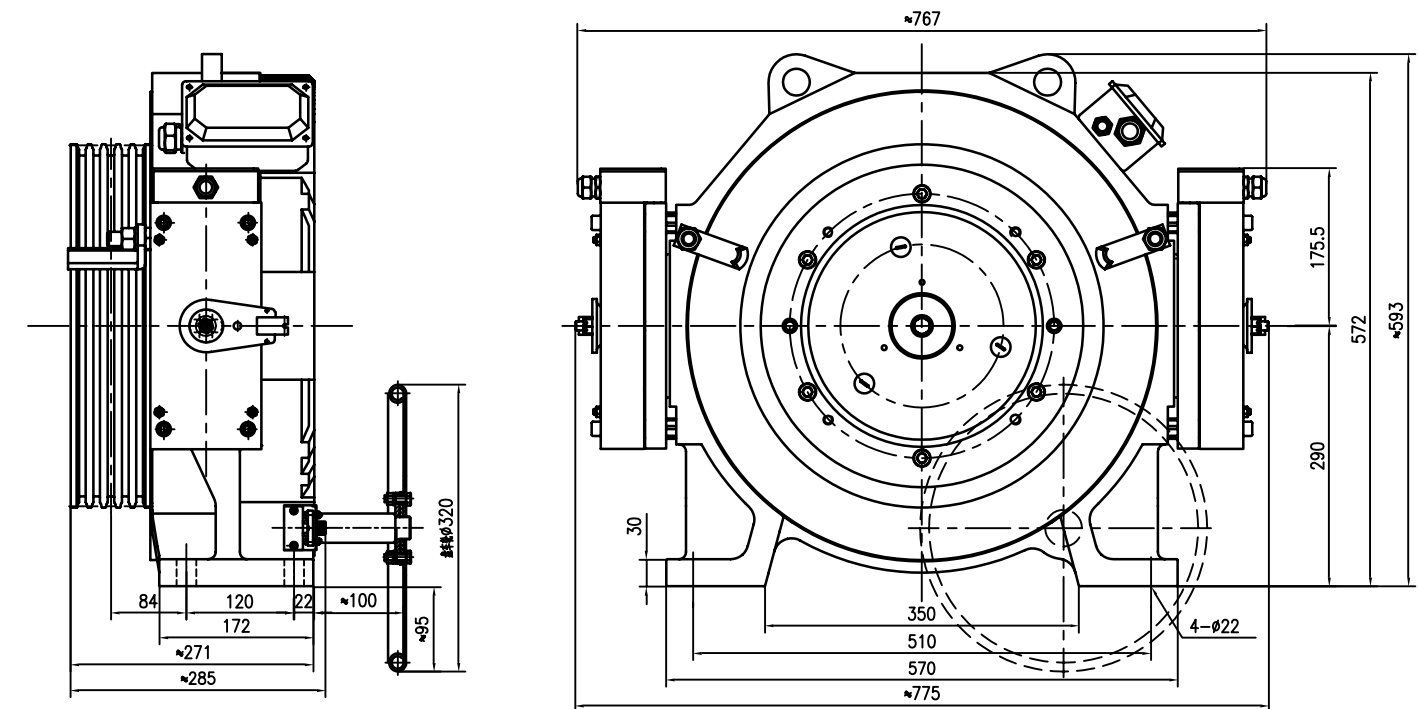

**注**

1. 本机型可配置远程松闸装置并带 4 米松闸线。
2. 推荐高度值仅供参考，超出推荐高度和工作制时，请联系我司技术接口确认。

**REMARK**

- 1.The machine can be configured with the remote manual brake release with 4 meters wire.
- 2.The recommended height is for reference only. Please contact our technical interface for confirmation when it exceeds the recommended height and the rating.